



# Prodis Arctic Series Chest Freezer

## Accessory Castor Kit Installation Manual

Kit Code: ARCASTOR01

Applicable Models: AR35OSS, AR45OSS, AR55OSS, AR65OSS

### ARCASTOR01 INSTALLATION DIAGRAM

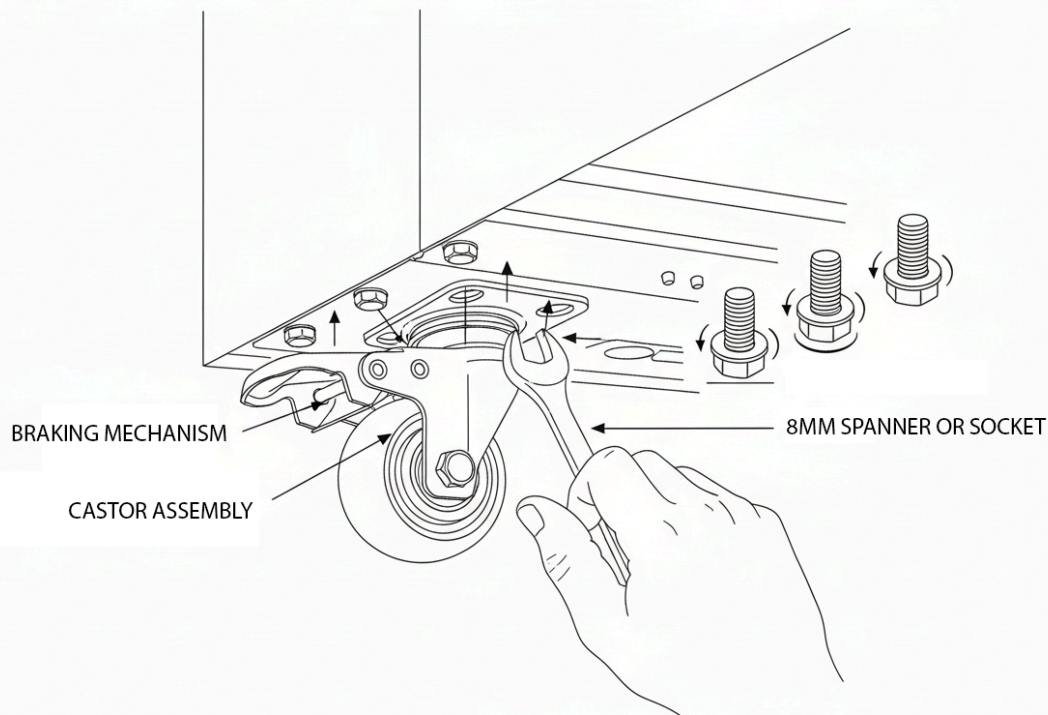

## 1. IMPORTANT: Safety First

Before you begin the installation, it is critical to ensure your safety and prevent damage to the appliance.

- **Disconnect Power:** Ensure the chest freezer is completely switched off and unplugged from the mains electrical supply.
- **Empty the Freezer:** Remove all contents from the freezer for safety and to make it lighter and easier to move.
- **Handle with Care:** The appliance is heavy. Use at least two people to lift or reposition the freezer to prevent injury.

## 2. Tools & Parts Supplied

### Tools Required:

- Socket set or 8mm spanner

### Parts Supplied (Kit ARCASTOR01):

- 2 x Standard Castors
- 2 x Braked (Locking) Castors
- 16 x 4.8 x 16mm Self-tapping Hex Head Bolts

## 3. Step-by-Step Installation Guide

### Step 1: Position the Freezer for Access

You have two options for gaining access to the underside of the freezer.

- **Option A (Elevate):** Securely elevate the chest freezer on stable supports (e.g., heavy-duty blocks). Ensure the unit is completely stable and cannot slip before working underneath.
- **Option B (Lay on its back):** Carefully lay the chest freezer onto its back. Take extreme care not to damage the rear hinge assembly when laying the unit down. Place it on a soft, protective surface like a blanket or cardboard to avoid scratches.

### Step 2: Remove Factory Fitted Feet

Locate the four original feet on the base of the freezer. Firmly grip each foot and unscrew it by turning counter-clockwise.

### Step 3: Fit the Braked Castors (Front)

We strongly advise fitting the two locking (braked) castors to the front of the freezer. This allows for easy access to engage and disengage the wheel brakes.

1. Take one of the braked castors and line up the holes on its flange plate with the pre-drilled holes on the base of the freezer.
2. Using a socket set or spanner, secure the castor by tightening the four supplied 4.8 x 16mm hex head bolts. Ensure the bolts are tight and the castor is firmly attached.
3. Repeat for the second braked castor on the other front corner.

### Step 4: Fit the Standard Castors (Rear)

Repeat the process from Step 3 for the two standard (non-braked) castors on both rear corners of the freezer.

### Step 5: Return the Freezer to the Upright Position

- **If Elevated:** Carefully lower the freezer back to the floor.
- **If on its Back:** Carefully lift the unit back to its upright position. It is essential to **chock the rear castors** before tilting it up to prevent it from rolling away unexpectedly.



### Step 6: CRITICAL - Settling Period

If you laid the freezer on its back (Option B), you **MUST** leave the unit standing in its final upright position for 24 HOURS before plugging it in and switching it on. This allows the refrigerant oils and gases to settle, preventing damage to the compressor.

## 4. Operating the Braked Castors

The brakes are designed for simple, hands-free operation.

- **To Engage Brake:** Apply firm downward pressure to the brake lever with your toe until it clicks and locks the wheel.
- **To Disengage Brake:** Use your toe to lift the brake lever upwards until the wheel is free to move.

Once the installation is complete and the settling period has passed (if required), you may plug in and restart your freezer.